

A08031.60



Single Bundle, A08031.60

## Single Bundles

For versatility in routing and positioning of light, flexible bundles are your answer.

### Features

- Tight bending radius for easy routing.
- A variety of standard sizes. See chart below for part numbers and specifications. Dual and quad bundles are found on a separate page in the product catalog. (05.02.01)
- The standard output ferrules accept spot lenses accept polarizing caps. (See the Accessories section of the product catalog for more details.)
- Standard input accepts Dichroic color filters, diffusers and ColdVision Series light sources.
- Support products are available in the Support Apparatus section of the product catalog. Adaptors may be required.
- Custom configurations are available. Lead time is required.

Bundles				
Part No.	Active Input Fiber Diameter	Distal Ferrule Diameter	Tubing Diameter	Bundle Length
A08020.40	.20" (5)	.393" (10)	.39" (10)	40" (1016)
A08020.60	.20" (5)	.393" (10)	.39" (10)	60" (1524)
A08025.40	.25" (6)	.393" (10)	.47" (12)	40" (1016)
A08025.60	.25" (6)	.393" (10)	.47" (12)	60" (1524)
A08031.40	.30" (8)	.393" (10)	.47" (12)	40" (1016)
A08031.60	.30" (8)	.393" (10)	.47" (12)	60" (1524)
A08031.80	.30" (8)	.393" (10)	.47" (12)	80" (2032)
A08051.40	.51" (13)	.625" (16)	.75" (19)	40" (1016)
A08051.60	.51" (13)	.625" (16)	.75" (19)	60" (1524)
A21200	.40" (10)	.507" (13)	.69" (18)	30" (762)

Dimensions in ( ) are in mm

# Single Bundles

Dimensions in ( ) are in mm

**Ringlight Input:** Black Anodized Aluminum

**Bundle Sheathing:** PVC Covered Metal Tubing

Product improvements may result in specification or feature changes without notice.

**Warning:** This product is manufactured with glass fiber. Not for use in cable/hose carrier. Call SCHOTT to discuss moving cable/hose carrier applications.

**A08020.40 - A08051.60**  
Single Bundles

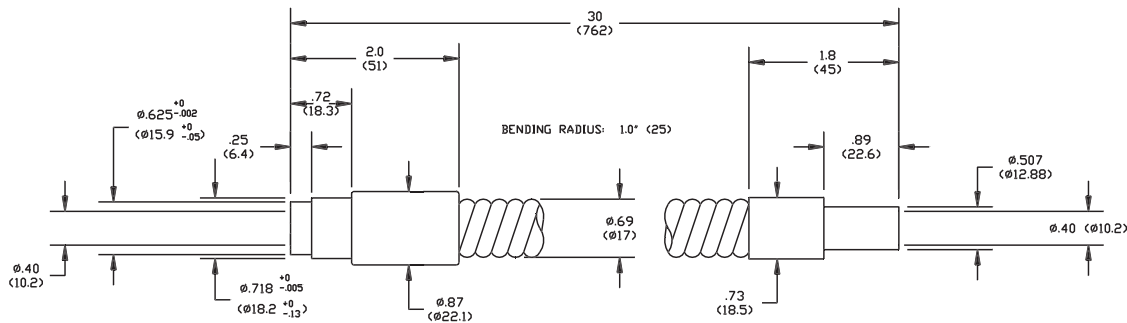
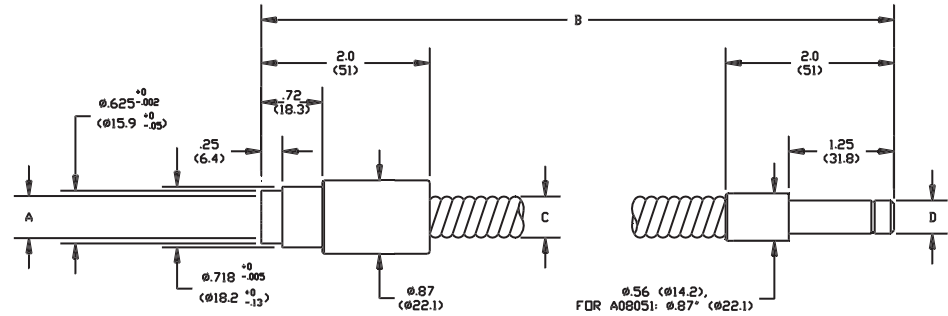

**A21200**  
Bundle

**Matrix for A08020.40 - A08051.60 Bundles**

Part No.	A	B	C	Bend Radius	D
<b>A08020.40</b>	.20" (5)	40" (1016)	.39" (10)	.5" (13)	.393" (10)
<b>A08020.60</b>	.20" (5)	60" (1524)	.39" (10)	.5" (13)	.393" (10)
<b>A08025.40</b>	.25" (6)	40" (1016)	.47" (12)	.6" (15)	.393" (10)
<b>A08025.60</b>	.25" (6)	60" (1524)	.47" (12)	.6" (15)	.393" (10)
<b>A08031.40</b>	.30" (8)	40" (1016)	.47" (12)	.6" (15)	.393" (10)
<b>A08031.60</b>	.30" (8)	60" (1524)	.47" (12)	.6" (15)	.393" (10)
<b>A08031.80</b>	.30" (8)	80" (2032)	.47" (12)	.6" (15)	.393" (10)
<b>A08051.40</b>	.51" (13)	40" (1016)	.75" (19)	1.4" (36)	.625" (16)
<b>A08051.60</b>	.51" (13)	60" (1524)	.75" (19)	1.4" (36)	.625" (16)
<b>A21200</b>	.40" (10)	30" (762)	.69" (18)	1.0" (25)	.507" (13)

**ISLAND OPTICAL SINGAPORE (S) PTE LTD**

No.18 Boon Lay Way  
#08-121 TradeHub 21  
Singapore 139944  
Phone: (65) 6515-9110  
Fax: (65) 6515-9112  
E-mail: islandos@pacific.net.sg  
www.islandos.com.sg

**SCHOTT**  
glass made of ideas